

Top profile  
type 461  
Galv 1,25 mm

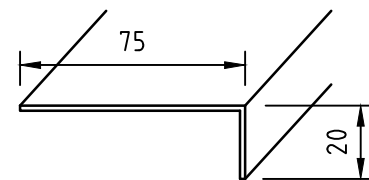

L profile  
type 466  
Galv 1,25 mm

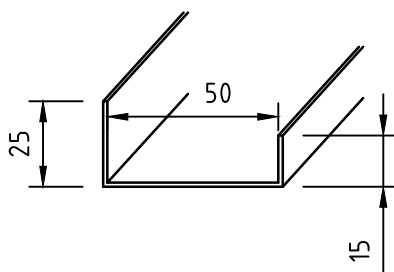

Bottom profile  
type 151  
Galv 1,25 mm

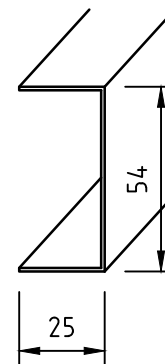

U profile  
type 461  
Galv 1,25 mm

PVC or painted  
thickness 0,6 mm

**JMC 1 A-60**

**SBA** INTERIOR

Page  
**1**

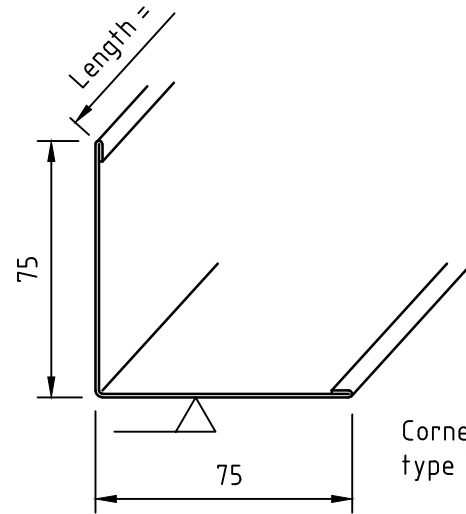
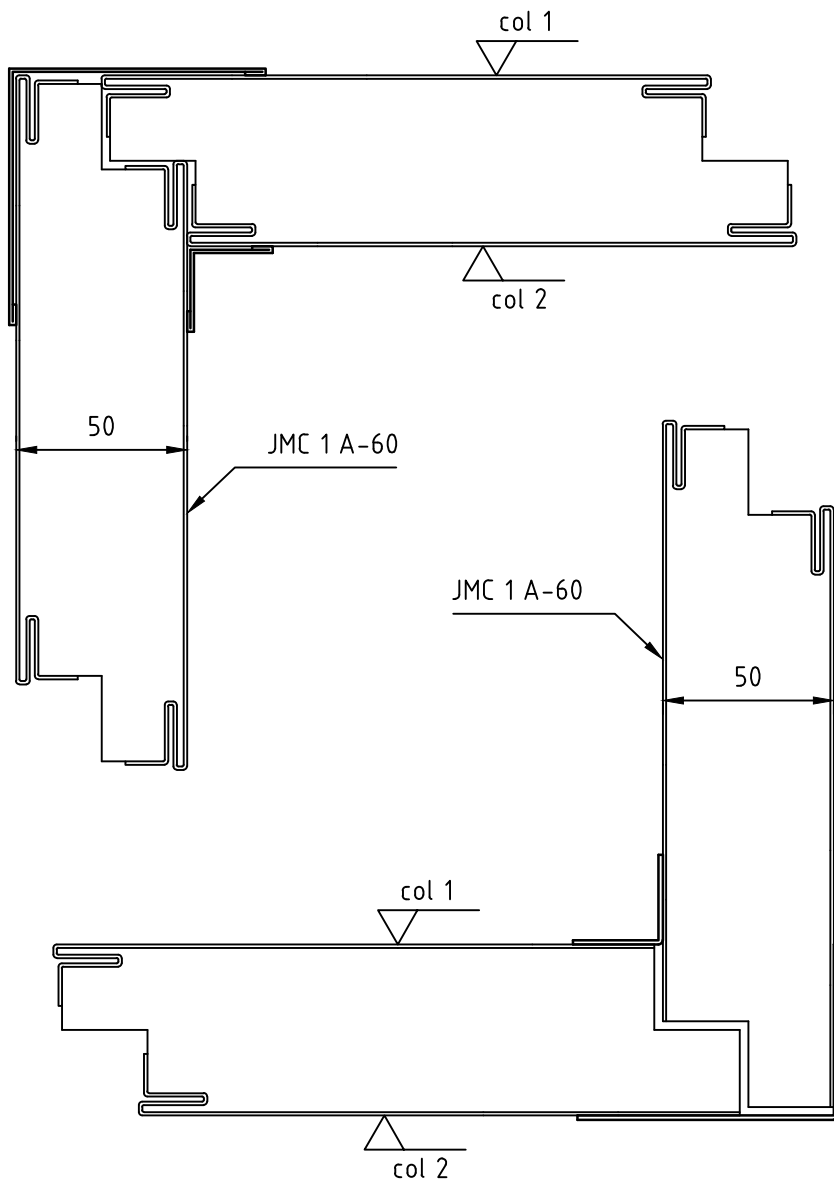

Corner profile out  
type 304

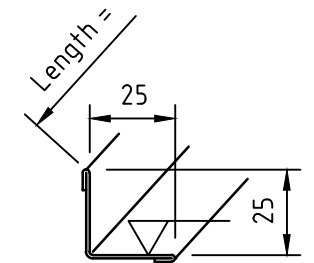

Corner profile in  
type 305

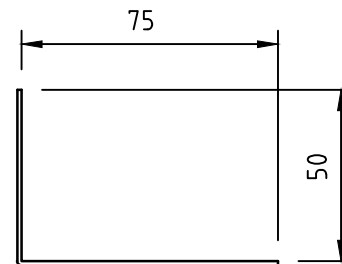

L profile  
type 464  
Galv 1,25 mm

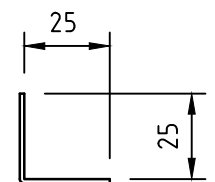

L profile  
type 462  
Galv 1,25 mm

PVC or painted  
thickness 0,6 mm

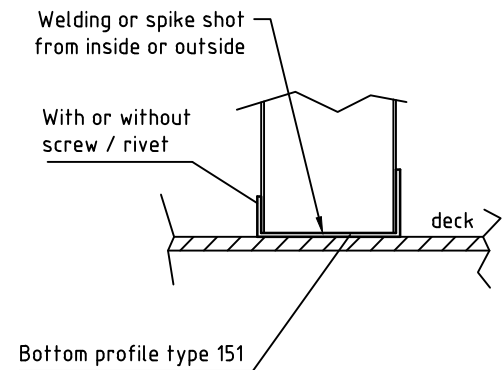
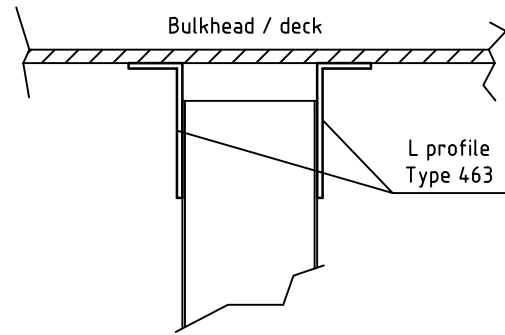
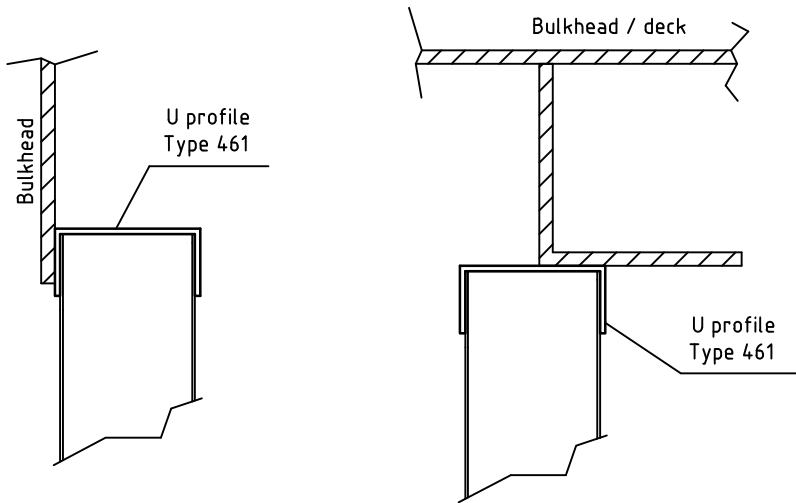
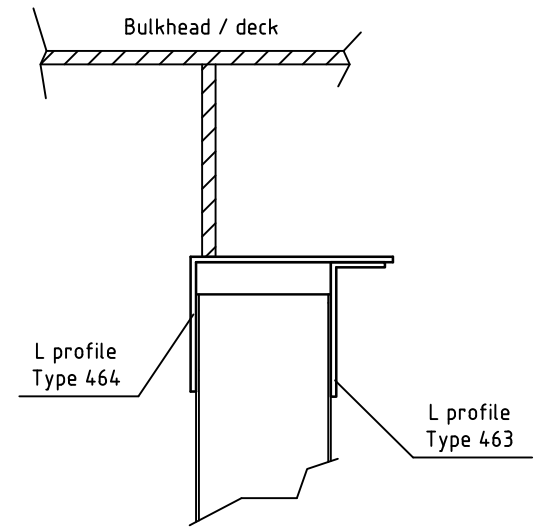
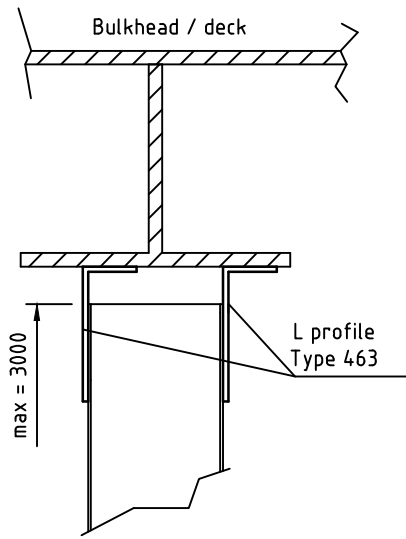
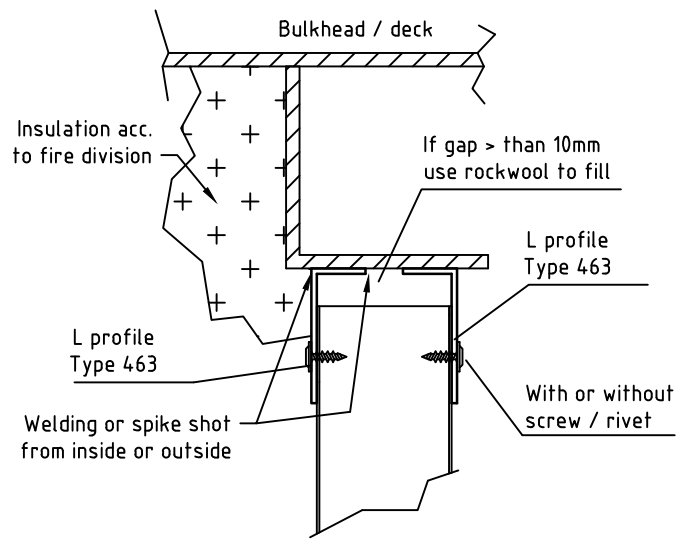

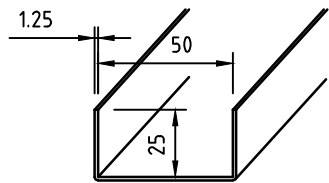

Connection profile  
type 461  
Galv 1,25 mm

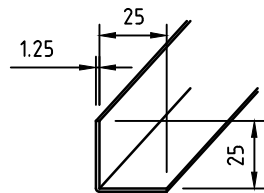

Connection profile  
type 462  
Galv 1,25 mm

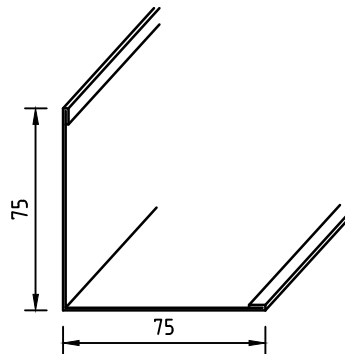

Corner profile  
type 304  
PVC / painted 0,6 mm

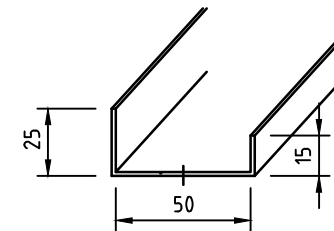

Bottom profile  
type 151  
Galv 1,25 mm

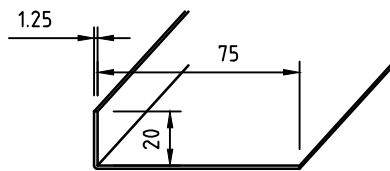

Connection profile  
type 466  
Galv 1,25 mm

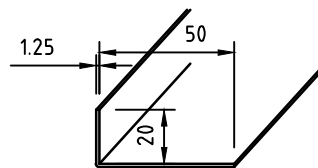

Connection profile  
type 463  
Galv 1,25 mm

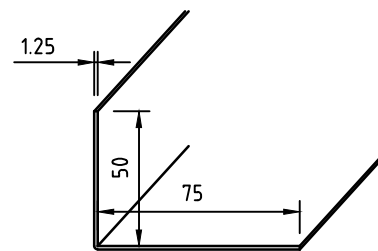

Connection profile  
type 464  
Galv 1,25 mm

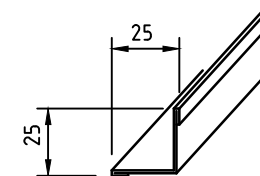

Corner profile  
type 305  
PVC / painted 0,6 mm

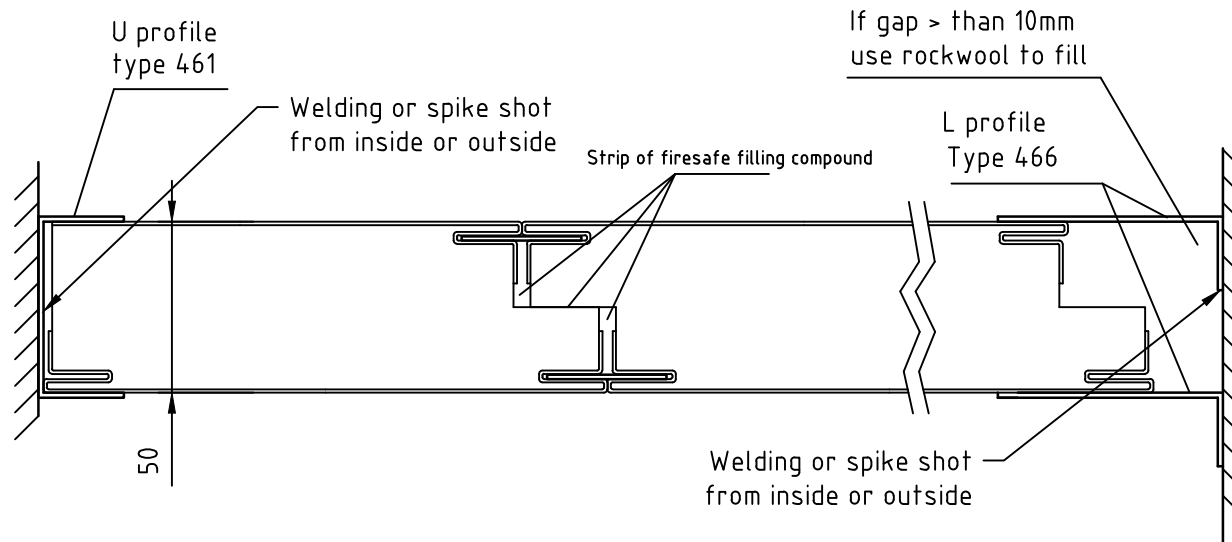
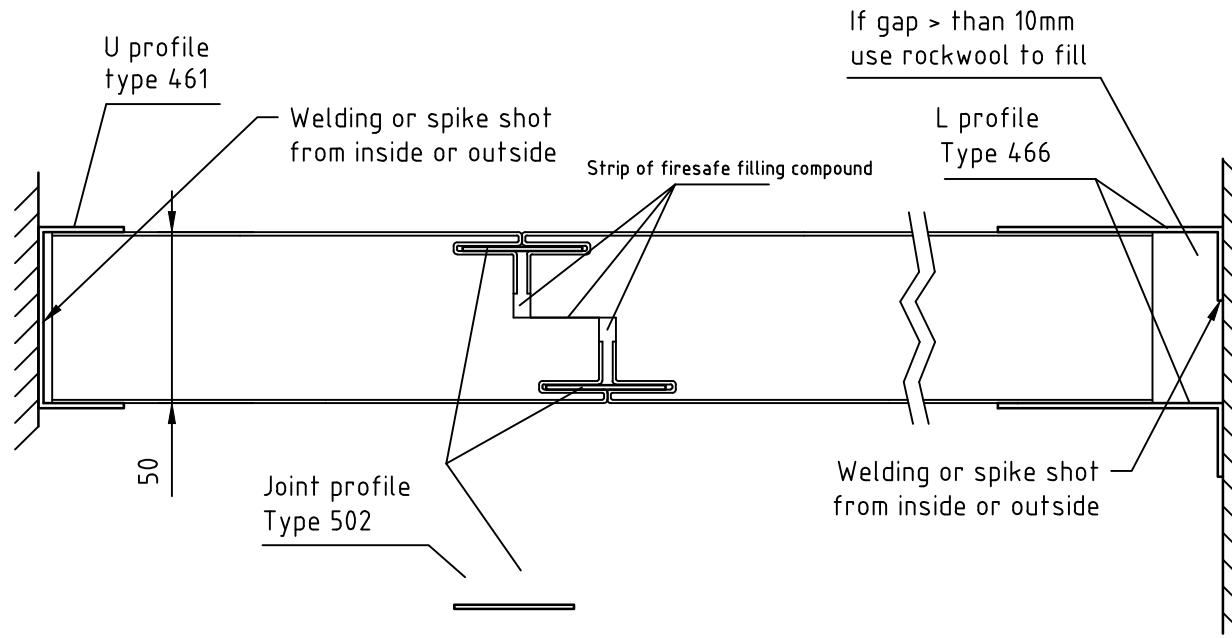

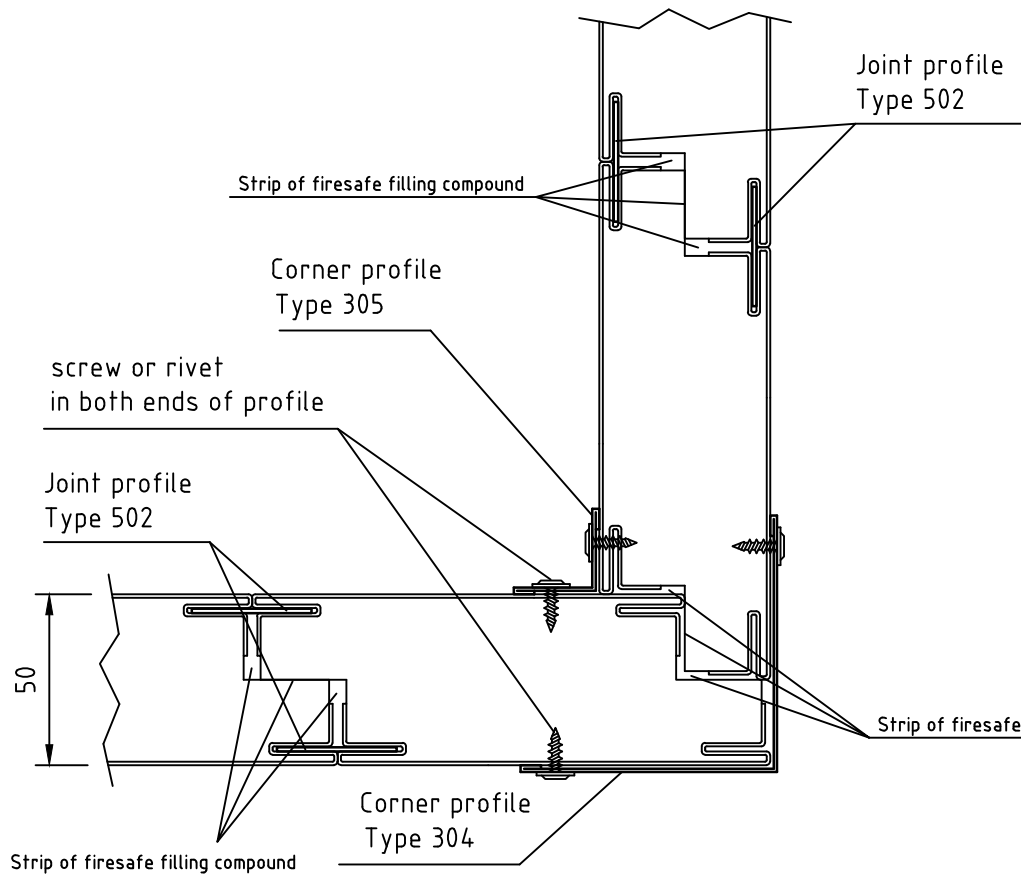

Corner with uncut bulkhead panel

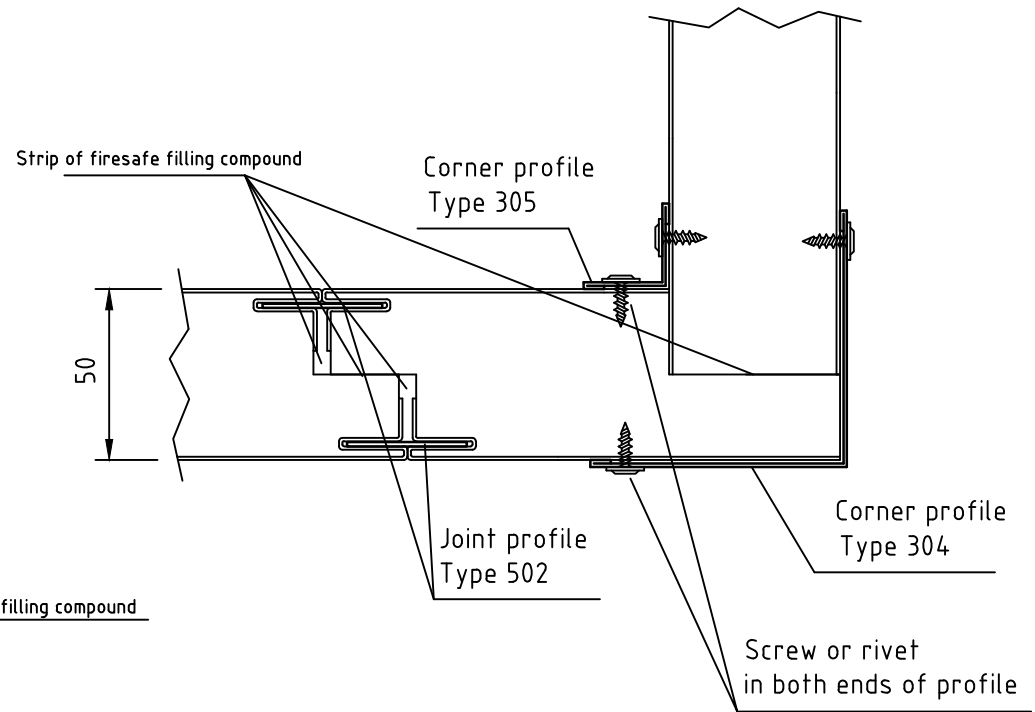

Corner with cut bulkhead panel

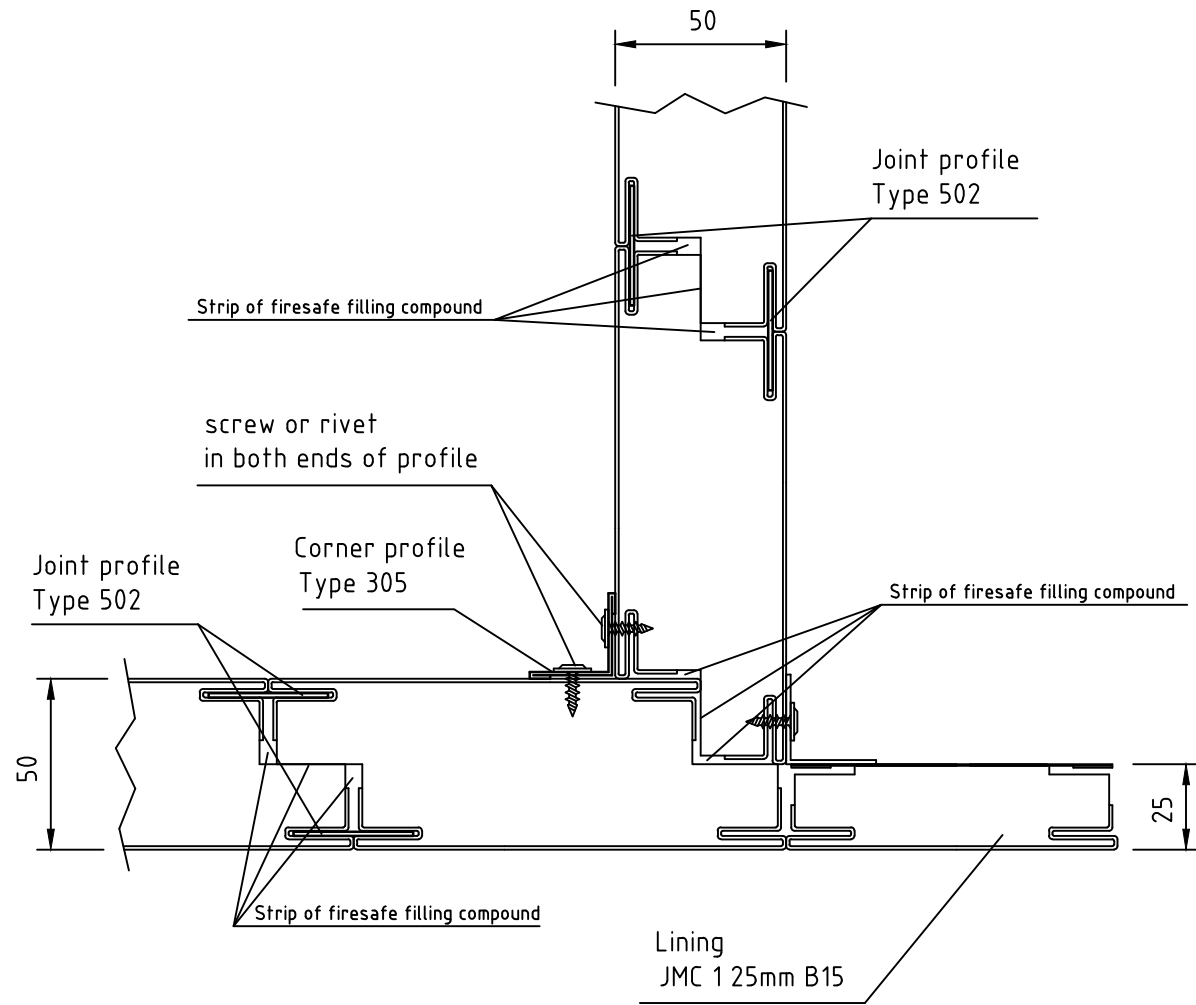

JMC 1 A-60

**SBA** INTERIOR

Page  
7

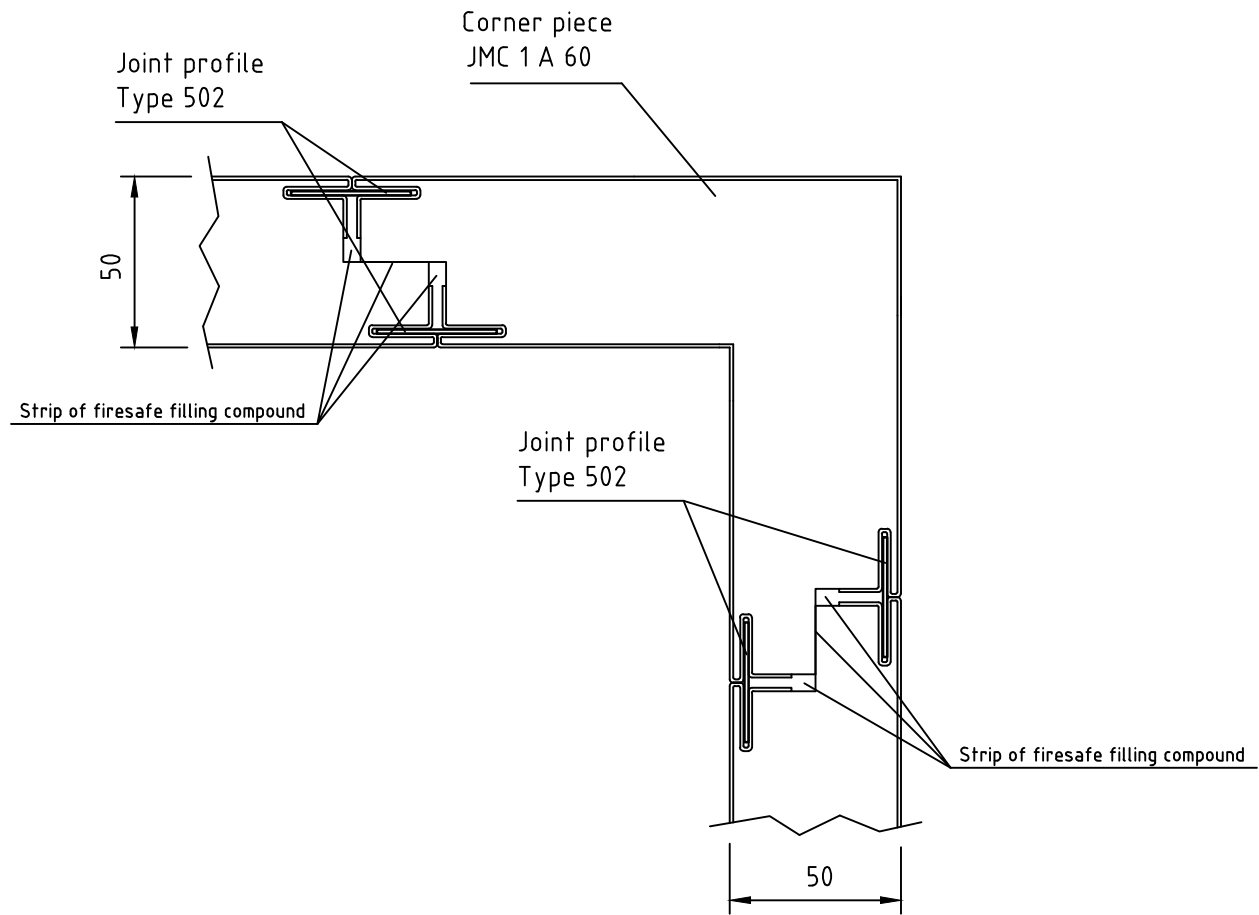

JMC 1 A-60

**SBA** INTERIOR

Page  
8



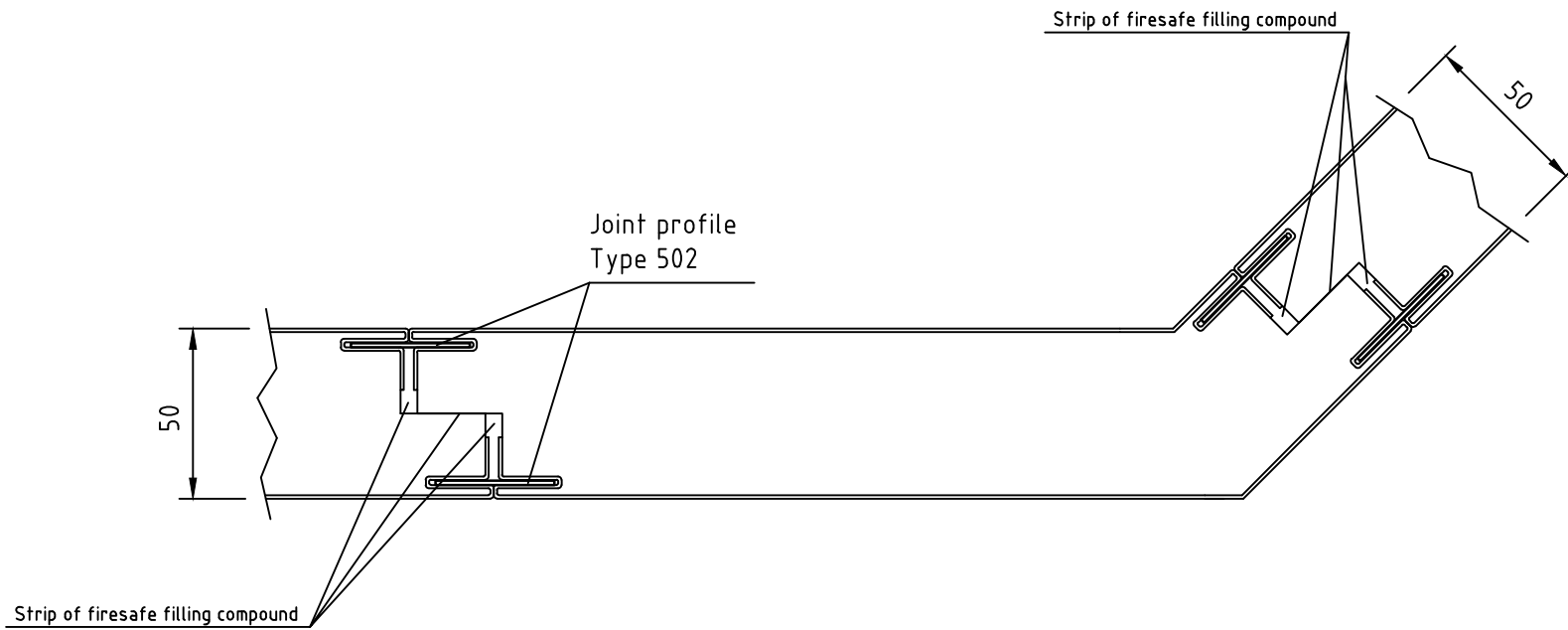

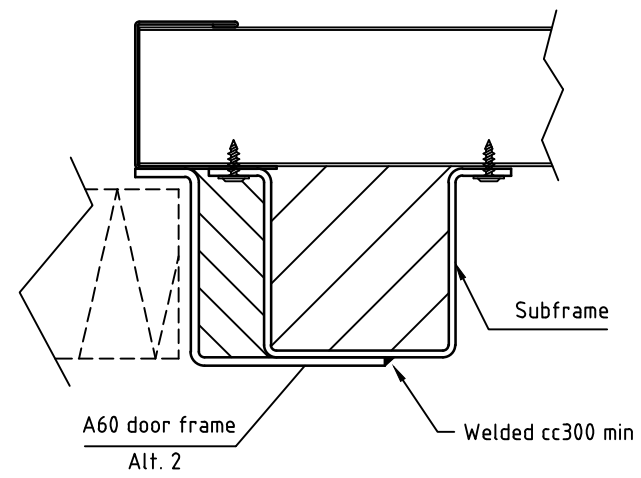
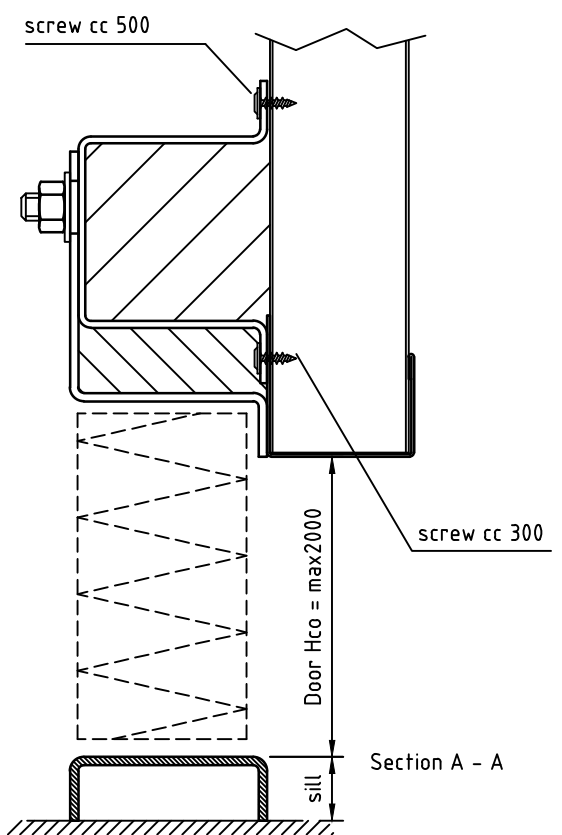
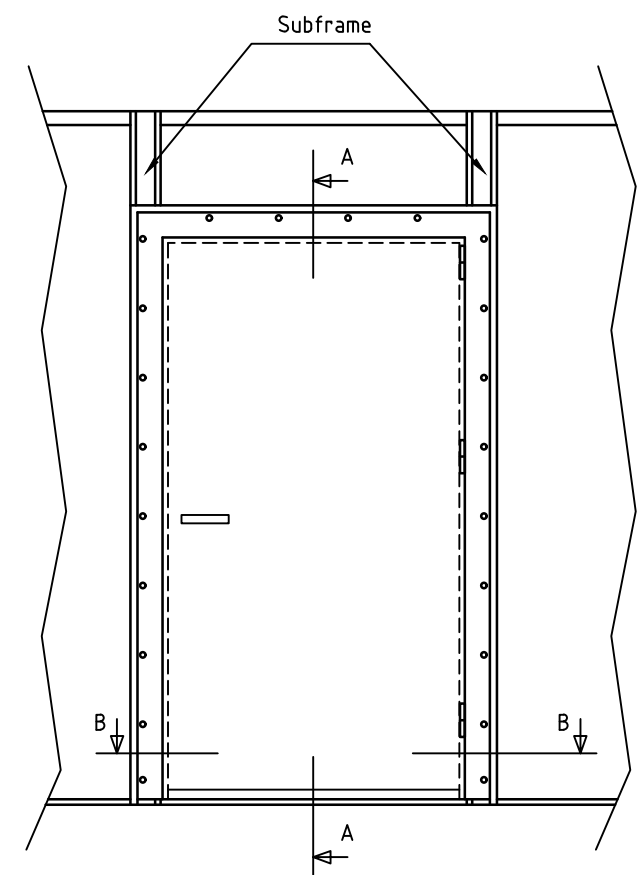
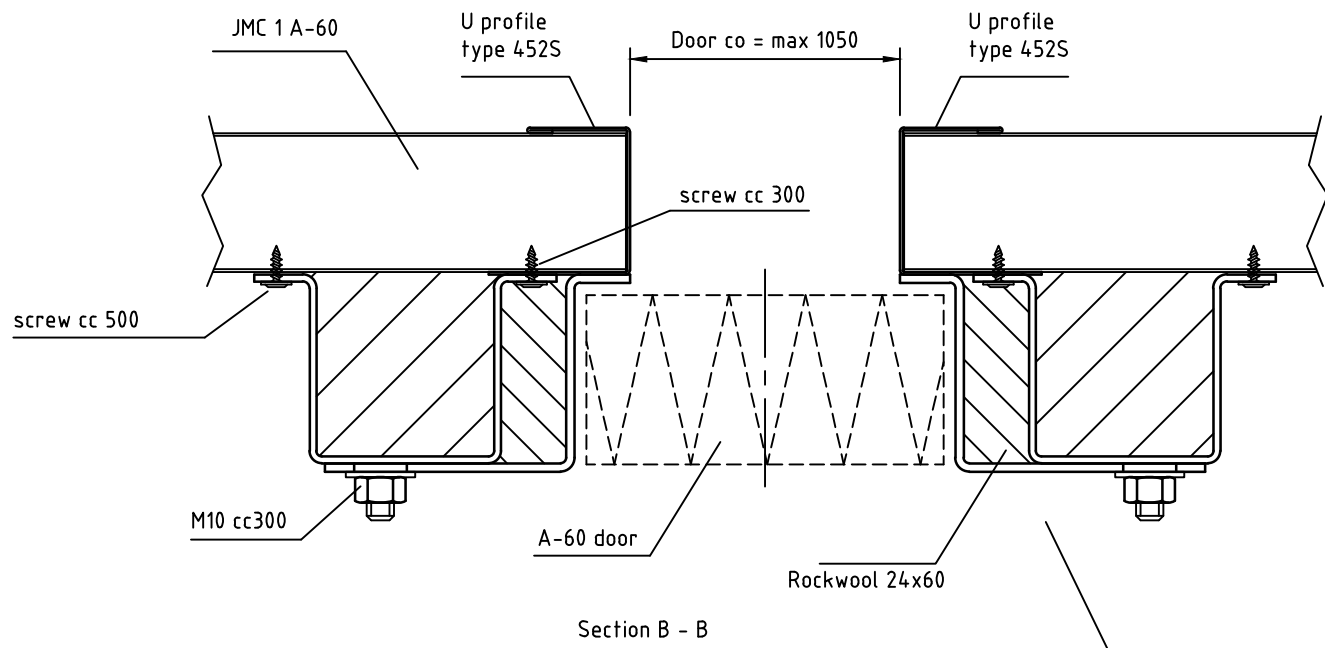

**JMC 1 A-60**  
**A-60 Door connection**



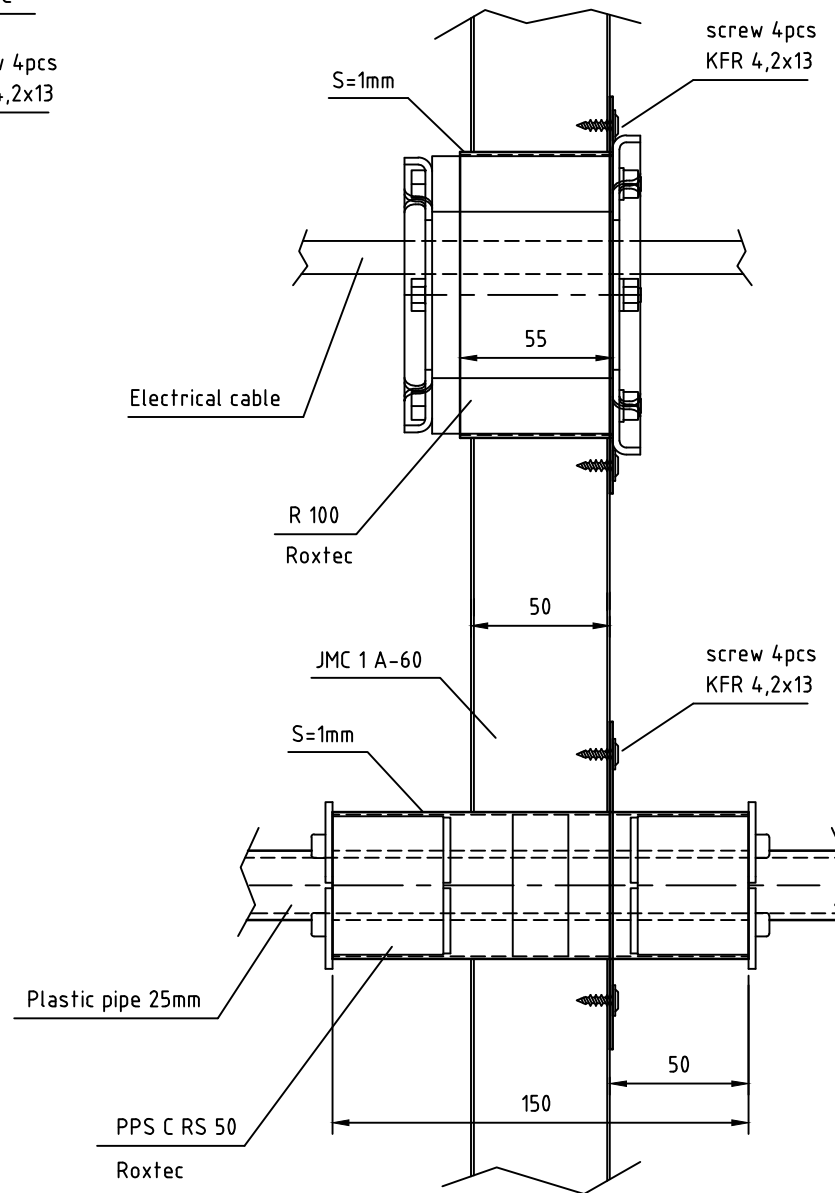
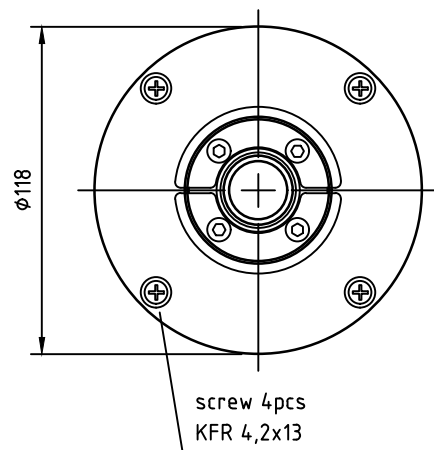
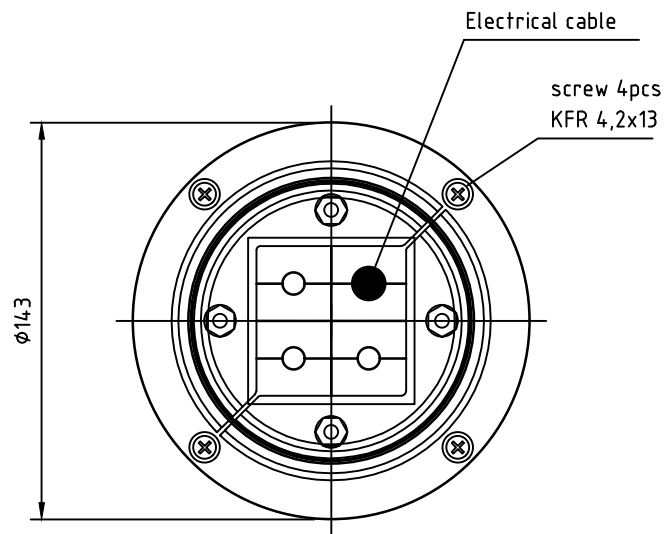

**JMC 1 A-60**  
**Penetrations**

**SBA** INTERIOR

Page  
11

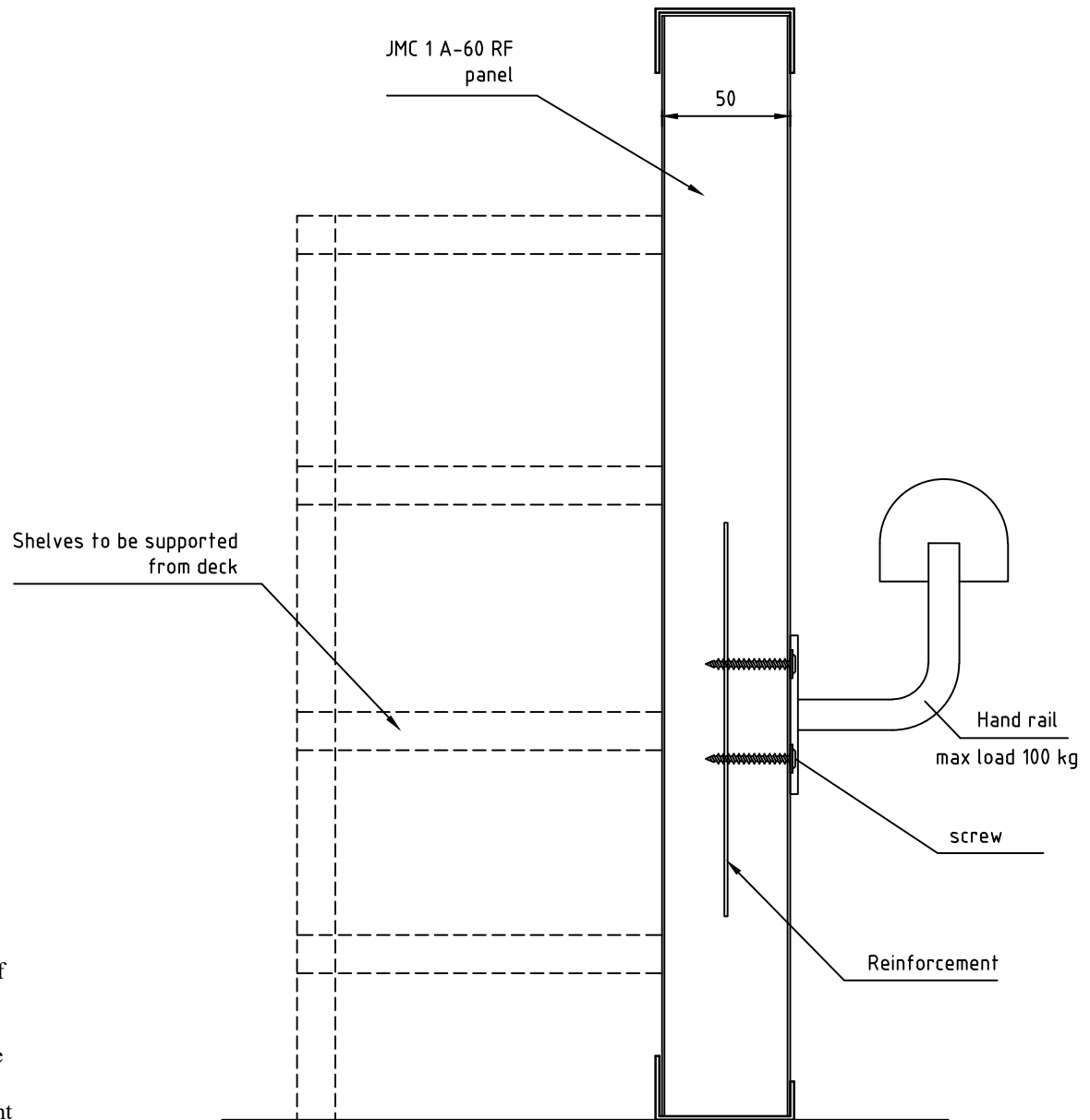

**Regulations II-2/3.3.1 and 3.3.2**

**Application of “light-weight constructions”**

“Light-weight constructions” (honeycomb type, etc.) of steel or equivalent material may be used as non load-bearing internal “A” class divisions in accommodation and service spaces, provided they have successfully passed the relevant standard fire test according to resolution A.754(18)\*. These “light-weight constructions” should not be used as an integral part of main fire zone bulkheads and stairway enclosures on passenger ships.